



2.5.1

Mechanism of Internal assessment is transparent and robust in term of frequency and mode

- Question paper setting**
- Conduction**
- Assessment**
- Result Declaration**



**Shri Vithal Education & Research Institute's
College of Engineering, Pandharpur**

**Frequency of Internal Examination
followed as per the Academic Calendar**



AUG 2022	1	2	3	4	5	6	7	8	9	10	11	12	13	14	15	16	17	18	19	20	21	22	23	24	25	26	27	28	29	30	31
	MON	TUE	WED	THU	FRI	SAT	SUN	MON	TUE	WED	THU	FRI	SAT	SUN	MON	TUE	WED	THU	FRI	SAT	SUN	MON	TUE	WED	THU	FRI	SAT	SUN	MON	TUE	WED
	SEM START						C		F1	ATT	F2		SESSION ON VOCA-TIONAL	C	FNI / SVI / GMS		ATT Section	NESC ENT PROG RAM SYIC	CRT Trainin g/ATT Sessio n/LY	CRT Trainin g/ATT Sessio n/LY		CSR TRAI NING SYIC	CSR TRAI NING SYIC	CSR TRAI NING SYIC	CSR TRAI NING SYIC	CSR TRAI NING SYIC	CSR TRAI NING SYIC	CSR TRAI NING SYIC	CRT Trainin g/ATT Sessio n/LY	CRT Trainin g/ATT Sessio n/LY	F3
SEPT 2022	1	2	3	4	5	6	7	8	9	10	11	12	13	14	15	16	17	18	19	20	21	22	23	24	25	26	27	28	29	30	
	THU	FRI	SAT	SUN	MON	TUE	WED	THU	FRI	SAT	SUN	MON	TUE	WED	THU	FRI	SAT	SUN	MON	TUE	WED	THU	FRI	SAT	SUN	MON	TUE	WED	THU	FRI	
					FND				ARCM			NI LAB	NI LAB	NI LAB	FNI / SVI / GMS	DPST NI LAB	NI LAB		ISE-I	ISE-I	D/ISE-I	ISE-I	ISE-I	LT/AT T Sessio n	LT/AT T Sessio n	LT/AT T Sessio n	LT/AT T Sessio n	LT/AT T Sessio n	LT/AT T Sessio n	HP/50	
OCT 2022	1	2	3	4	5	6	7	8	9	10	11	12	13	14	15	16	17	18	19	20	21	22	23	24	25	26	27	28	29	30	31
	SAT	SUN	MON	TUE	WED	THU	FRI	SAT	SUN	MON	TUE	WED	THU	FRI	SAT	SUN	MON	TUE	WED	THU	FRI	SAT	SUN	MON	TUE	WED	THU	FRI	SAT	SUN	MON
		FNI / SVI / GMS		HP/50	F4		RSHM	ELITE	F5	EDP PROG RAM	EDP PROG RAM	SCM/ EDP PROG		MOD K PARI	OR		ISE-II	ISE-II	ISE-II	ISE-II	ISE-II	F6	F6	F6	F6	F6		LT	LT	C	LT
NOV 2022	1	2	3	4	5	6	7	8	9	10	11	12	13	14	15	16	17	18	19	20	21	22	23	24	25	26	27	28	29	30	
	TUE	WED	THU	FRI	SAT	SUN	MON	TUE	WED	THU	FRI	SAT	SUN	MON	TUE	WED	THU	FRI	SAT	SUN	MON	TUE	WED	THU	FRI	SAT	SUN	MON	TUE	WED	
	LT/D	LT/R	F7	F7		C	HP/50	F8							SCM					IV	IV				HP/50	SC	PM	ISE-II	ISE-II	ISE-II	
DEC 2022	1	2	3	4	5	6	7	8	9	10	11	12	13	14	15	16	17	18	19	20	21	22	23	24	25	26	27	28	29	30	31
	THU	FRI	SAT	SUN	MON	TUE	WED	THU	FRI	SAT	SUN	MON	TUE	WED	THU	FRI	SAT	SUN	MON	TUE	WED	THU	FRI	SAT	SUN	MON	TUE	WED	THU	FRI	SAT

JAN 2023	1	2	3	4	5	6	7	8	9	10	11	12	13	14	15	16	17	18	19	20	21	22	23	24	25	26	27	28	29	30	31	
	SUN	MON	TUE	WED	THU	FRI	SAT	SUN	MON	TUE	WED	THU	FRI	SAT	SUN	MON	TUE	WED	THU	FRI	SAT	SUN	MON	TUE	WED	THU	FRI	SAT	SUN	MON	TUE	
		UE	UE	UE	UE	UE	UE		UE	UE	FC	GMS	B	F10	SEM START		ATT									FNI/5V		SCM			MP/50	
FEB 2023	1	2	3	4	5	6	7	8	9	10	11	12	13	14	15	16	17	18	19	20	21	22	23	24	25	26	27	28				
	WED	THU	FRI	SAT	SUN	MON	TUE	WED	THU	FRI	SAT	SUN	MON	TUE	WED	THU	FRI	SAT	SUN	MON	TUE	WED	THU	FRI	SAT	SUN	MON	TUE				
		ARC M				GRM					IV	IV			HP/50		F11	FNT	ISE-I	ISE-I	ISE-I	ISE-I/D	ISE-I	LT		LT	LT					
MAR 2023	1	2	3	4	5	6	7	8	9	10	11	12	13	14	15	16	17	18	19	20	21	22	23	24	25	26	27	28	29	30	31	
	WED	THU	FRI	SAT	SUN	MON	TUE	WED	THU	FRI	SAT	SUN	MON	TUE	WED	THU	FRI	SAT	SUN	MON	TUE	WED	THU	FRI	SAT	SUN	MON	TUE	WED	THU	FRI	
	LT	LT/R					FNI/50		HP/50	F12					HP/50		PM			ELOC	F13		SCM		C	ISE-II	ISE-II	ISE-II	F14	ISE-II		
APR 2023	1	2	3	4	5	6	7	8	9	10	11	12	13	14	15	16	17	18	19	20	21	22	23	24	25	26	27	28	29	30		
	SAT	SUN	MON	TUE	WED	THU	FRI	SAT	SUN	MON	TUE	WED	THU	FRI	SAT	SUN	MON	TUE	WED	THU	FRI	SAT	SUN	MON	TUE	WED	THU	FRI	SAT	SUN		
	ISE-II	C	LT/D	F15	LT	LT	F16	LT/R	C					FNI/5V				UGP	UGP		F17	G			UGS					C		
MAY 2023	1	2	3	4	5	6	7	8	9	10	11	12	13	14	15	16	17	18	19	20	21	22	23	24	25	26	27	28	29	30	31	
	MON	TUE	WED	THU	FRI	SAT	SUN	MON	TUE	WED	THU	FRI	SAT	SUN	MON	TUE	WED	THU	FRI	SAT	SUN	MON	TUE	WED	THU	FRI	SAT	SUN	MON	TUE	WED	
	F18	SC			F19		C	ISE-II	ISE-II	ISE-II	ISE-II	ISE-II	LT		LT	LT	LT	LT/R						IO	IO	PG	PG	PG	PG	R&D	R&D	UE



**Shri Vithal Education & Research Institute's
College of Engineering, Pandharpur**

**In Semester Examination (ISE)
Question paper setting**

SVERI's
College of Engineering Pandharpur
Department of Electronics and Telecommunication
Engineering

A.Y. 2021-22 SEM-I

ISE

- **Office Order**



**Shri Vithal Education & Research Institute's
College of Engineering, Pandharpur**

Conduction of In Semester Examination (ISE)

- **Circular**
- **Notice**
- **Time Table**
- **Seating Arrangement**
- **Supervision Duty Sheet**

Circular



Shri Vithal Education & Research Institute's COLLEGE OF ENGINEERING, PANDHARPUR

P.B.No. 54, Gopalpur - Ranjani Road, Gopalpur, Pandharpur - 413 304, Dist. Solapur (Maharashtra) Tel.: 7755990201.

Toll Free No.: 1800-3000-4131, E-mail: coe@sveri.ac.in, Website: www.sveri.ac.in (Approved by A.I.C.T.E., New Delhi and Affiliated to Solapur University, Solapur)

Accredited by The Indian Institution of Engineers (India), Kolkata and TCS, Pune. ISO 9001:2008 Certified Institute



Ref.: COEPR/2017-18/CI/67(A)
Circular

Date:- 03/01/2018

All the Students and Staff are hereby informed to note that the policy in respect of In Semester Examination (ISE) marks has been modified through the resolution in Students' Council meeting dated 12/10/2017. The modified policy is as given below:

- 1) If student passes in all the three ISEs of the Subject (Course) then the average of the best of two ISEs be considered for finalising ISE marks of that Subject (Course) for sending to University.
- 2) If student fails in one or more ISEs of Subject (Course) then the average of all the three ISEs is to be considered for finalising ISE marks of that subject for sending to University.
- 3) Student failing in or remaining absent for Subject(s)[(Course)(s)] in ISE(s) or willing to improve the performance in one or more Subject(s)[(Course)(s)] ,at his/her choice may opt for Re-ISE(s) ,within five days from the date of declaration of the concerned ISE result, once for each Subject (Course) by paying charges of Rs.300/- per Subject (Course) of ISE.
- 4) This policy be reflected in every notice of ISE henceforth.
- 5) This circular be part of Subject file under A2 as per Circular no.SVERI/2010-11/CIR/85 (A) dated 01/01/2011, alongwith other relevant circulars.

The policy shall come into force from Semester -II of the Academic Year 2017-18.
All the concerned should take note of the above and act accordingly.

B.P. Ronge
(Dr.B.P.Ronge)
PRINCIPAL

C.C.:

- | | | | |
|--------------|---|----------------------------------|--------------------------|
| 1) All Deans | 2) All HODS : For effective circulation | 3) All Subject (Course) Teachers | 4) College Notice Boards |
| 5) FTP | 6) Office Copy | 7) Office Copy | 8) Hostel Notice Board |

Revised Circular

All the Students and Staff are hereby informed to note that the policy in respect of In Semester Examination (ISE) has been revised through the resolution in Students' Council meeting dated 24/01/2019. The revised policy is as given below:

- 1) If student passes in all the three ISEs in a Subject (Course) then the average of the best of two ISEs be considered for finalising ISE mark of that subject (Course) for sending to University.
- 2) Student failing in or remaining absent for Subject(s) [(Course)s] in ISE(s) has to compulsory appear for Re-ISE(s), once for each Subject (course) by paying charges of Rs.100/- per Subject (Course) of ISE, as per the schedule decided by department.
- 3) Student clear pass in ISE, but willing to improve the performance in one or more Subject (s) [(Course)s] at his /her choice may opt for RE-ISE(s), once for each subject (Course) by paying charge of Rs. 100/- per subject (course) of ISE, as per the schedule decided by department.
- 4) If student fails in one or more ISEs of Subject (Course) then the average of all the three ISEs is to be considered for finalising ISE marks of that subject for sending to University.
- 5) This policy be reflected in every notice of ISE henceforth.
- 6) This circular be part of Subject file under A2 as per Circular no. SVERI/2010-11/CIR/85 (A) dated 01/01/2011, along with other relevant circulars.
- 7) The earlier circular in this respect No. COEPR/2017-18/Cir/67(A) dated 03/01/2018 stands cancelled.

The policy shall come into force from Sem-II of the Academic Year 2018-19.

All the concerned should take note of the above and act accordingly.



B. Ronge
(Dr. B. P. Ronge)
PRINCIPAL

C.C.

- | | | | |
|-------------------------|--------------------------|---|----------------------------------|
| 1) Campus Incharge | 2) All Deans | 3) All HODS : For effective circulation | 4) All Subject (Course) Teachers |
| 5) Hostel Notice Boards | 6) College Notice Boards | 7) FTP | 8) Office Copy |



SHRI VITHAL EDUCATION & RESEARCH INSTITUTE'S
COLLEGE OF ENGINEERING, PANDHARPUR
Gopalpur -Ranjani Road, Gopalpur, P.B. No. 54, Tal - Pandharpur- 413 304,
Dist. Solapur (Maharashtra) Ph. : (02186) 225083, Fax: (02186) 225082.
(Approved by A.I.C.T.E., New Delhi and affiliated to P.A.H.University, Solapur)
E-mail : coe@sveri.ac.in Website:www.sveri.ac.in

Date: 27/09/2022

NOTICE

All the faculty members and students of ENTC dept. are here by inform to note the following points regarding to In Semester Exam (ISE-I):

1. ISE-I will start from 3rd OCT 2022 to 8th OCT 2022 for L.Y. B.Tech.
2. ISE paper should be of 20 Marks, which is distributed as 04 Marks MCQ and 16 Marks descriptive questions.
3. ISE-I will be conducted on the SECTION-I syllabus of respective subjects.
4. There will be OBT for 10 marks and THT for 10 marks.

NOTE:

1. Student failing in or remaining absent for any subject in ISE or Willing to improve the performance in One or more subjects at his/ her choice may put for Re-ISE within three days from the declaration of concern ISE result, once for each subject by paying charges of Rs.100/- per subject of ISE.
2. If student fail in ISE, even though if student pass in University exam, it will be considered as fail in that particular subject.

T.S. Joshi

(Ms. T. S. Joshi)
Test Coordinator

Dr. Mrs. M. M. Pawar

(Dr. Mrs. M. M. Pawar)

HOD ENTC

Head

Dept. of Electronics & Telecomm.
Engg. SVERI'S C.O.E. Pandharpur



**SHRI VITHAL EDUCATION & RESEARCH INSTITUTE'S
COLLEGE OF ENGINEERING, PANDHARPUR.**

ISO 9001-2000 Certified Institute & Accredited by Institute of Engineers, India
Gopalpur -Ranjani Road, Gopalpur, P.B. No. 54, Tal - Pandharpur- 413 304,
Dist. Solapur (Maharashtra) Ph.: (02186) 225083, Fax: (02186) 225082.
(Approved by AICTE, New Delhi and affiliated to P.A.H.University, Solapur)
E-mail: coe@coep.ac.in

Date: 27-09-2022

**Department of Electronics and Telecommunication
Academic Year 2022-23 (SEM-I)**

**ISE-I Timetable
Class: LY (A&B)**

Sr.No	Subject	Date	Time
01	Machine Learning (ML)	03-10-22	10:00am - 11:30am
02	Data Communication (DC)	04-10-22	10:00am - 11:30am
03	Internet of Things (IoT)	06-10-22	10:00am - 11:30am
04	Database Management Systems (DBMS)	07-10-22	10:00am - 11:30am
05	Image and video Processing (IVP)	08-10-22	10:00am - 11:30am

T.S. Joshi

(Ms. T. S. Joshi)
Test Co-ordinator

(Dr.Mrs. M. M. Pawar)

H.O.D.ENTC
Head

**Dept. of Electronics & Telecomm.
Engg. SVERI'S C.O.E. Pandharpur**



SHRI VITHAL EDUCATION & RESEARCH INSTITUTE'S
COLLEGE OF ENGINEERING, PANDHARPUR

Gopalpur -Ranjani Road, Gopalpur, P.B. No. 54, Tal - Pandharpur- 413 304,
Dist. Solapur (Maharashtra) Ph. : (02186) 225083, Fax: (02186) 225082.
(Approved by A.I.C.T.E., New Delhi and affiliated to P.A.H.University, Solapur)
E-mail : coc@sveri.ac.in Website:www.sveri.ac.in

Date: 1/10/2022

Ref. No.

Office Order

The following faculty members of our department are entrusted with the duties for reviewing the ISE Question paper for the academic year 2022-23.

Sr. No	Area	Name of faculty
1	Communication System	Dr. M.S.Mathpati
2	Embedded System	Dr.Mrs.M.M.Pawar
3	Analog Electronics	Dr. A.K.Pandey
4	Digital Electronics	Mrs.J.S.Shinde
5	Others	Mrs.N.P.Kulkarni

All are requested to take the note of the same and act accordingly.

(Ms. T. S. Joshi)
Test Coordinator

(Dr. Mrs. M. M. Pawar)

HOD ENTC
Head
Dept. of Electronics & Telecomm.
Engg. SVERI'S C.O.E. Pandharpur



SHRI VITHAL EDUCATION & RESEARCH INSTITUTE'S
COLLEGE OF ENGINEERING, PANDHARPUR



ISO 9001:2015



P.B. No. 54, Gopalpur -Ranjani Road, Gopalpur, Tal.- Pandharpur- 413 304,Dist.- Solapur (Maharashtra)

Tel.: 02186-216063, 9503103757, E-mail : coe@sveri.ac.in, Website: www.sveri.ac.in

(Approved by A.I.C.T.E., New Delhi and affiliated to P. A. H. Solapur University, Solapur)

NBA Accredited all Eligible UG Programmes and , NAAC, Accredited Institute,

Accredited by The Institution of Engineers (India), Kolkata and TCS, Pune ISO 9001-2015 Certified Institute

DATE: 02/10/2022

Seating Arrangement for ISE-I

Block	Class and roll no. of students	Total no.of students
MF 417	L.Y. - A (01-38)	38
MF 419(Monday, Tuesday, Thursday) MF 418(Friday, Saturday)	L.Y. - B (01-36)	36
MF 426	L.Y. - A (39-52)	14
	L.Y. - B (37-48)	12

T.S. Joshi

(Ms. T. S. Joshi)

Test Coordinator

Dr. Mrs. M. M. Pawar

(Dr. Mrs. M. M. Pawar)

HOD ENTC

Head

Dept. of Electronics & Telecomm
Engg. SVERI'S C.O.E. Pandharpur



SHRI VITHAL EDUCATION & RESEARCH INSTITUTE'S
COLLEGE OF ENGINEERING, PANDHARPUR
Gopalpur -Ranjani Road, Gopalpur, P.B. No. 54, Tal - Pandharpur- 413 304,
Dist. Solapur (Maharashtra) Ph. : (02186) 225083, Fax: (02186) 225082.
(Approved by A.I.C.T.E., New Delhi and affiliated to P.A.H.University, Solapur)
E-mail : coe@sveri.ac.in Website:www.sveri.ac.in

Date: 10/10/2022

NOTICE

All the faculty members and students of ENTC dept. are here by inform to note the following points regarding to In Semester Exam (ISE-I):

1. ISE-I will start from 13th OCT 2022 to 15th OCT 2022 for T.Y. B.Tech.
2. ISE paper should be of 20 Marks, which is distributed as 04 Marks MCQ and 16 Marks descriptive questions.
3. ISE-I will be conducted on the 1/3rd syllabus of respective subjects.
4. There will be OBT(MCQ Type) for 10 marks and THT for 10 marks.
5. OBT should be given through the Google form having 10 MCQ.
6. THT should be given on the basis of research literature survey of related subject topic or Product development for hardware related subject or project related to subject.

NOTE:

1. Student failing in or remaining absent for any subject in ISE or Willing to improve the performance in One or more subjects at his/ her choice may put for Re-ISE within three days from the declaration of concern ISE result, once for each subject by paying charges of Rs.100/- per subject of ISE.
2. If student fail in ISE, even though if student pass in University exam, it will be considered as fail in that particular subject.

T.S. Joshi

(Ms. T. S. Joshi)

Test Coordinator

M. M. Pawar
(Dr. Mrs. M. M. Pawar)

HOD ENTC
Head

Dept. of Electronics & Telecomm.,
Engg. SVERI'S C.E.T., Pandharpur



**SHRI VITHAL EDUCATION & RESEARCH INSTITUTE'S
COLLEGE OF ENGINEERING, PANDHARPUR.**

ISO 9001-2000 Certified Institute & Accredited by Institute of Engineers, India
Gopalpur -Ranjani Road, Gopalpur, P.B. No. 54, Tal - Pandharpur- 413 304,
Dist. Solapur (Maharashtra) Ph.: (02186) 225083, Fax: (02186) 225082.
(Approved by AICTE, New Delhi and affiliated to P.A.H.University, Solapur)
E-mail: coe@coep.ac.in

Date: 10-10-2022

Department of Electronics and Telecommunication

Academic Year 2022-23 (SEM-I)

ISE-I Timetable

Class: TY (A&B)

Sr.No	Subject	Date	Time
01	Electromagnetic Field Theory (EMFT)	13-10-22	10:00am - 11:30am
02	Microcontroller and application (MCA)	13-10-22	01:00pm - 02:30pm
03	Digital Signal Processing (DSP)	14-10-22	10:00am - 11:30am
04	Project Management & Operation Research (PM&OR)	14-10-22	01:00pm - 02:30pm
05	Data Processing & Feature Engineering (DP&FE)	15-10-22	10:00am - 11:30am

T.S.Joshi
(Ms. T. S. Joshi)
Test Co-ordinator

(Dr. Mrs. M. M. Pawar)

H.O.D.ENTC

Head

Dept. of Electronics & Telecomm.
Engg. SVERI'S C.E.E. Pandharpur



SHRI VITHAL EDUCATION & RESEARCH INSTITUTE'S
COLLEGE OF ENGINEERING, PANDHARPUR
Gopalpur -Ranjani Road, Gopalpur, P.B. No. 54, Tal - Pandharpur- 413 304,
Dist. Solapur (Maharashtra) Ph. : (02186) 225083, Fax: (02186) 225082.
(Approved by A.I.C.T.E., New Delhi and affiliated to P.A.H.University, Solapur)
E-mail : coc@sveri.ac.in Website:www.sveri.ac.in

Date: 11/11/2022

NOTICE

All the faculty members and students of ENTG dept. are hereby inform to note the following points regarding to In Semester Exam (ISE-I):

1. ISE-I will start from 16th NOV 2022 to 21st NOV 2022 for S.Y. B.Tech.
2. ISE paper should be of 20 Marks, which is distributed as 04 Marks MCQ and 16 Marks descriptive questions.
3. ISE-I will be conducted on the minimum 2 chapters of respective subjects.
4. There will be OBT(MCQ) for 10 marks.

NOTE:

- 1.Student failing in or remaining absent for any subject in ISE or Willing to improve the performance in One or more subjects at his/ her choice may put for Re-ISE within three days from the declaration of concern ISE result, once for each subject by paying charges of Rs.100/-per subject of ISE.
- 2.If a student fails in ISE, even if the student passes the University exam, it will be considered as a failure in that particular subject.

T.S.Joshi

(Ms. T. S. Joshi)

Test Coordinator

(Signature)

(Dr.Mrs. M. M. Pawar)

HOD ENTG
Head

Dept. of Electronics & Telecomm.
Engg. SVERI'S C.O.E. Pandharpur

Sveri's College of Engineering Pandharpur
Department Electronic and Telecommunication
Academic Year 2021-22, SEM - I
Supervision Duty for ISE - I

SR.NO.	Name of Faculty	Date	Time	Block	Sign
1	Mr. A. K. Pandey	04-10-22	10:00 to 11:30	LY (411)	
		08-10-22	10:00 to 11:30	MF 418	
2	Mr. J. S. Hallur	06-10-22	10:00 to 11:30	MF 418	
		07-10-22	10:00 to 11:30	MF 418	
3	Mr. M. A. Deshmukh	04-10-22	10:00 to 11:30	MF 426	
		08-10-22	10:00 to 11:30	MF 426	
4	Mr. Ranjit Pyati	07-10-22	10:00 to 11:30	MF 418	
		08-10-22	10:00 to 11:30	MF 418	
5	Ms. M. Biswas	03-10-22	10:00 to 11:30	MF 419	
		07-10-22	10:00 to 11:30	MF 418	
6	Ms. S. S. Pawar	03-10-22	10:00 to 11:30	MF 417	
		06-10-22	10:00 to 11:30	MF 418	
7	Ms. S. S. Gavade	03-10-22	10:00 to 11:30	MF 426	
		06-10-22	10:00 to 11:30	MF 419	
8	Ms. T. S. Joshi	04-10-22	10:00 to 11:30	MF 419	

Common Instructions to Faculty for smooth conduction of ISE-I

- 1 Report 10 min. before of your supervision duty to test co-ordinator.
- 2 Don't allow late comers in the class.
- 3 Circulate the attendance sheet after 1 hour.
- 4 Before 1 don't allow any student to go outside of the classroom.
- 5 Submit answer sheet in sequential manner.
- 6 Fill all the details of attendance sheet.

(Dr. Mrs. M. M. Pawar)

**H.O.D. ENTTC
 Head**

Dept. of Electronic & Telecommunication
ENSE - SVERI'S COLLEGE, PANDHARPUR



**SHRI VITHAL EDUCATION & RESEARCH INSTITUTE'S
COLLEGE OF ENGINEERING, PANDHARPUR.**

ISO 9001-2000 Certified Institute & Accredited by Institute of Engineers, India
Gopalpur -Ranjani Road, Gopalpur, P.B. No. 54, Tal - Pandharpur- 413 304,
Dist. Solapur (Maharashtra) Ph.: (02186) 225083, Fax: (02186) 225082.
(Approved by AICTE, New Delhi and affiliated to P.A.H.University, Solapur)
E-mail: coe@coep.ac.in

Date: 11-11-2022

Department of Electronics and Telecommunication

Academic Year 2022-23 (SEM-I)

ISE-I Timetable

Class: SY (A&B)

Sr.No	Subject	Date	Time
01	Engineering Mathematics -III	16-11-22	10:30am-12:00pm
02	Electronic Circuit and Design	17-11-22	10:30am-12:00pm
03	Network theory and Analyses	18-11-22	10:30am-12:00pm
04	Digital Technique	19-11-22	10:30am-12:00pm
05	Analog Communication	21-11-22	10:30am-12:00pm

T.S.Joshi

(Ms. T. S. Joshi)

Test Co-ordinator

M.M.Pawar

(Dr.Mrs. M. M. Pawar)

H.O. DENTC
Head

Dept. of Electronics & Telecomm.
Engg. SVERI'S C.O.E. Pandharpur



SHRI VITHAL EDUCATION & RESEARCH INSTITUTE'S
COLLEGE OF ENGINEERING, PANDHARPUR



ISO 9001:2015



P.B. No. 54, Gopalpur -Ranjani Road, Gopalpur, Tal.- Pandharpur- 413 304, Dist.- Solapur (Maharashtra)

Tel.: 02186-216063, 9503103757, E-mail : coc@sveri.ac.in, Website: www.sveri.ac.in

(Approved by A.I.C.T.E., New Delhi and affiliated to P. A. H. Solapur University, Solapur)

NBA Accredited all Eligible UG Programmes and , NAAC, Accredited Institute,

Accredited by The Institution of Engineers (India), Kolkata and TCS, Pune ISO 9001-2015 Certified Institute

DATE: 15/11/2022

Seating Arrangement for ISE

Block	Class and roll no. of students	Total no.of students
MF 417	SY A (1 TO 36) + Roll no. 77	37
	LY A (1 to 24)	24
MF 423	SY A (37 TO 76)	40
	LY A (25 TO 52)	27
MF 424	SY B (1 TO 40)	40
	LY B (1 TO 37) + Roll NO. 48	38
MF 426	SY B (41 TO 61)	21
	LY B (38 TO 47)	10

T.S. Joshi

(Ms. T. S. Joshi)

Test Coordinator

M.M. Pawar

(Dr. Mrs. M. M. Pawar)

HOD ENTC
Head

Dept. of Electronics & Telecomm.
Engg. SVERI'S C.O.E. Pandharpur

SVERI's College of Engineering, Pandharpur
Department of Electronics and Telecommunication Engineering

Class: S.Y.B.Tech (A&B) ISE-I A.Y.: 2022-23 SEM-I

ET-212 Electronic Circuit Analysis and Design

Day and Date: 17/11/2022

Max. Marks -20 marks

Time-10:30 A.M.to 12:00 PM.

Duration-1 hr 30 min

CO	CO STATEMENT	LEVEL	MAX. MARKS
ET212.1	Explain the concepts of Bipolar junction transistor, single stage and multistage CE amplifier.	BL3	20

Instructions - 1) All Questions are compulsory.

2) Assume Suitable Data If Required.

Q.I) MCQ'S /objectives type questions(1M*4=4M)		CO	BL	Marks
1.	Stability factor for _____ bias is $(1 + \beta)$. a) Voltage divider b) Fixed c) Emitter bias d) None	ET212.1	BL2	(01)
2.	BJT in CE configuration has $I_C=10$ mA and $I_b=100\mu A$ find the current gain. a. 100 b. 10 c. 0.1 d. 0.001	ET212.1	BL2	(01)
3.	In active mode of operation of a BJT ____ a. Emitter-Base junction is reverse biased and Collector to Base junction is reverse biased b. Emitter to Base junction is forward biased and Collector to Base junction is reverse biased c. Emitter to Base junction is forward biased and CB junction is forward biased d. Emitter to Base junction is reverse biased and CBJ is forward biased	ET212.1	BL2	(01)
4.	For transistor with self-biasing network , the following components are used : $R_1=4K\Omega$, $R_2=4K\Omega$ and $R_E=1K\Omega$,the approximate value of stability factor will be a) 4 b) 3 c) 2 d) 1.5	ET212.1	BL2	(01)
Q.II) Attempt any Four from the following (4M*4=16M)		CO	BL	Marks
1.	Explain different biasing techniques for BJT amplifier and explain Fixed bias circuit.	ET212.1	BL2	(04)
2.	Define Stability factor and derive stability factor for Voltage divider bias circuit.	ET212.1	BL2	(04)
3.	Compare CB, CE and CC configuration of Bipolar Junction transistor.	ET212.1	BL2	(04)
4.	Derive expression for A_v , A_i , R_i and R_o for transistor amplifier using voltage divider bias.	ET212.1	BL3	(04)
5.	Derive the relationship between: 1) α and β 2) I_{CBO} and I_{CEO}	ET212.1	BL3	(04)
6.	Explain Early effect in BJT amplifier	ET212.1	BL2	(04)

[Handwritten Signature]
15/11/22



SHRI VITHAL EDUCATION & RESEARCH INSTITUTE'S

COLLEGE OF ENGINEERING, PANDHARPUR

P.B. No. 54, Gopalpur -Ranjani Road, Gopalpur, Tal.- Pandharpur- 413 304, Dist.- Solapur (Maharashtra)

Tel.: 02186-216063, 9503103757, E-mail : coe@sveri.ac.in, Website: www.sveri.ac.in

(Approved by A.I.C.T.E., New Delhi and affiliated to Solapur University, Solapur)

NBA Accredited all Eligible UG Programmes and , NAAC, Accredited Institute,

Accredited by the Institute of Engineers (India), Kolkata and TCS, Pune ISO 9001-2015 Certified Institute



ISO 9001:2015



www.tuv.com
ID 8109048194

Ref No: COEPR/2022-23/

Date: 15/11/2022

Department of Electronics & Telecommunication Engineering Question Paper Reviewing Report

Class: 3.Y.B.Tech.

Div: A&B

Test: ISE-I

Academic Year: 2022-23

Name of subject teacher:- Mr. A.B. Choude (Div. B), Dr. A.K. Pandey (Div. A)

Name of Reviewer:-

A]

Sr. No.	Recommended/Not Recommended	If not recommended comments of reviewer	Sign of Reviewer
1.	Recommended		

B] HOD Remark: -----

(Dr. M.M. Pawar)

HOD ENTIC Engg. Dept.

Dept. of Electronics & Telecomm.
Engg. SVERI'S C.O.E. Pandharpur

SVERI's College of Engineering, Pandharpur
Department of Electronics and Telecommunication Engineering
 Class: T.Y.(A&B) ISE-III A.Y.: 2022-23 SEM-II

Antenna Wave Propagation

Day and Date: 1/06/2023 Marks -30 Time-10:00a.m.to11:30a.m. Duration-1:30 hr.

CO	CO STATEMENT	LEVEL	MAX. MARKS
ET321.4	Explain the types and application of antenna	BL3	14
ET321.5	Discuss the characteristics of radio wave propagation	BL3	06

Instructions - 1) All Questions are compulsory. 2) Assume Suitable Data If Required.

Q.I) MCQ'S /objectives type questions(1M*2=2M)		CO	BL	PI	Marks
1	Rumsey's principle is related to which type of antennas? a) Frequency independent antennas b) Reflector antennas c) Frequency dependent antennas d) both a & c	ET321.4.	BL3	2.1.2	(01)
2	The dipoles in the inactive transmission region offer ----- impedance. a)Capacitive b)Resistive c)Inductive d)Characteristic	ET321.4.	BL3	2.1.2	(01)
Q.II) MCQ'S /objectives type questions(1M*2=2M)		CO	BL	PI	Marks
1	Upto which frequency the ground wave propagation is used? a) 2MHz b)2GHz c)30MHz d)30GHz	ET321.5.	BL2	2.1.2	(01)
2	Which of the following is the lowest layer of atmosphere? a)Troposphere b) Stratosphere c)Ionosphere d)Outer atmosphere	ET321.5.	BL2	2.1.3	(01)
Q.III) Attempt any one from the following (4M*3=12M)		CO	BL	PI	Marks
1	Explain Microstrip antenna .Also denote its feeding techniques	ET321.4.	BL3	2.1.2	(04)
2	Give details of Log-periodic antenna	ET321.4.	BL3	2.1.3	(04)
3	Explain Spiral Antenna.	ET321.4.	BL3	2.1.3	(04)
4	Explain Active antenna	ET321.4.	BL3	2.1.2	(04)
Q.IV) Attempt any three from the following (4M*1=4M)		CO	BL	PI	Marks
1	Explain Modes of propagation.	ET321.5.	BL3	2.1.3	(04)
2	Explain the structure of atmosphere.	ET321.5.	BL3	2.1.3	(04)
3	Give details of ground wave propagation.	ET321.5.	BL3	2.1.4	(04)

.....All the Best.....

To
The HOD,
ENTC Dept,
SVERI's COE Pandharpur

Subject - About RE-ISE

Respected Madam,

I am Minal Shrikant
Mhamane. Studying in LY ENTC having
Roll No. 20 & Div - B

I was absent on Friday
07/11/2022, so kindly consider my application
& allow me to attend RE-ISE
DBMs ISE Because of Health issue.

Thanking You

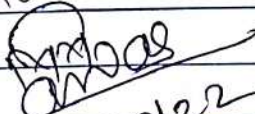
Allowed

18/11/22

Your's Faithfully
Mhamane
[Mhamane M.S.]

SVERI's College of Engineering, Pandharpur

Department of Electronics and Telecommunication Engineering

Class: L.Y. (A&B) RE- ISE-I A.Y.: 2022-23 SEM-I

Data Communication

Day and Date: 19/10/2022
Time-5:15p.m. to 6:30p.m.

Marks -30
Duration-1 hr 15 min

CO	CO STATEMENT	LEVEL	MAX. MARKS
ET 412.1	Understand basics of network layers & devices.	BL2	10
ET412.2	Explain the different protocols of data link layer.	BL2	10

Instructions - 1) All Questions are compulsory.
2) Assume Suitable Data If Required.

Q.I) MCQ'S /objectives type questions(1M*4=4M)		CO	BL	PI	Marks
1.	Which of the following is an application layer service? A) File transfer and access B) Mail service C) Remote log-in D) All the above	ET 412.1	BL2	2.1.1	(01)
2.	In Go-Back-N ARQ, if frames 4, 5, and 6 are received successfully, the receiver may send an ACK _____ to the sender. A) 6 B) 7 C) 5 D) any of the above	ET 412.1	BL2	2.1.1	(01)
3.	In cyclic redundancy checking, what is the CRC? a)The quotient b)The dividend c)The divisor d)The remainder	ET412.2	BL2	2.1.1	(01)
4.	Which one of the following network devices stores the IP addresses? A) Router B) Switch C) Both a and b D) None of the above	ET412.2	BL2	2.1.1	(01)
Q.II) Attempt any two from the following (4M*2=8M)		CO	BL	PI	Marks
1.	Explain the function of each layer in TCP/IP model.	ET 412.1	BL2	2.1.1	(04)
2.	Explain the functionality of Switches & Bridges.	ET 412.1	BL2	2.1.1	(04)
3.	Explain any two network topologies with their advantages and disadvantages.	ET 412.1	BL2	2.1.1	(04)
Q.III) Attempt any two from the following (4M*2=8M)		CO	BL	PI	Marks
1.	Explain Sliding Window Protocol with suitable example.	ET412.2	BL2	1.4.1	(04)
2.	Write a note on a) Repeaters b) Routers	ET412.2	BL2	1.4.1	(04)
3.	Describe CSMA/CD in details .	ET412.2	BL2	1.4.1	(04)

.....All the Best.....



Shri Vithal Education & Research Institute's
College of Engineering, Pandharpur

**Assessment of In Semester Examination
(ISE)**



**Shri Vithal Education & Research Institute's
College of Engineering, Pandharpur**

In Semester Examination (ISE)

- **Marking Scheme of Assessment**
- **Answer Sheet**
- **Circular for Timely Assessment**
- **Result**



**Shri Vithal Education & Research Institute's
College of Engineering, Pandharpur**

In Semester Examination (ISE)

- **Marking Scheme of
Assessment**



**Shri Vithal Education & Research Institute's
College of Engineering, Pandharpur**

In Semester Examination (ISE)

- **Circular for Timely Assessment**



Shri Vithal Education & Research Institute's
COLLEGE OF ENGINEERING, PANDHARPUR

Date: 1/06/2023

ISE / Unit Test No.: 03

Name of Student: Dipli Dilip More.

Class: TY

Division: B

Roll No.: 22

Subject: AWP

Sign of Supervisor: *[Signature]*

Marks: $\frac{17}{20}$

CO:	BL	PI Code	Q.No.	a	b	c	d	e	f	Total
4	3	2.1.2	1	1	1					2
4	3	2.1.2 2.1.3	2	1	1					2
4	3	2.1.2 2.1.3	3	3	3	3				10
5	3	2.1.3	4	3						3
			5							
			6							
			7							
			8							
									Grand Total	17

Q.1

1 a) frequently independent antennas

2 a) capacitive

Q.2

1 a) 3MHz

2 a) troposphere

1)

Microstrip antenna :-

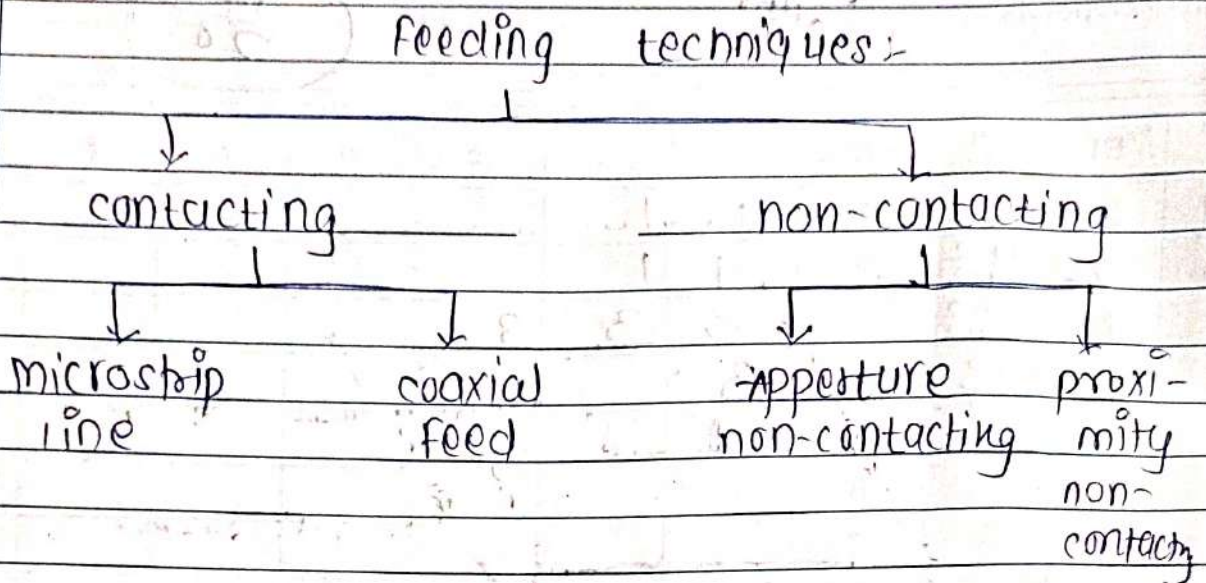

→ Microstrip antenna :-

When we use thick dielectric substrate then there is low dielectric const & it also having better performance & also having good radiation only disadvantage is it having compact structure so for that we are using the high dielectric material.

Microstrip antenna :-

This also known as patch antenna.

Microstrip antenna having different shapes :-



Disc

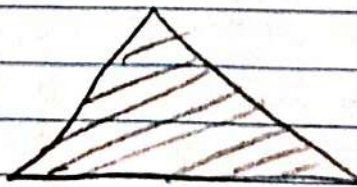

triangle

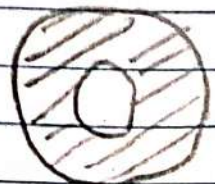

ring

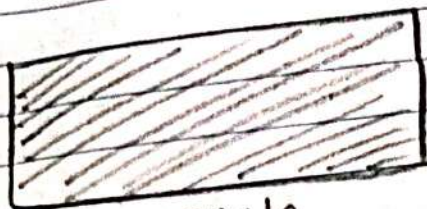

rectangle.

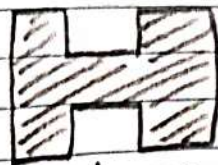

H-shape.

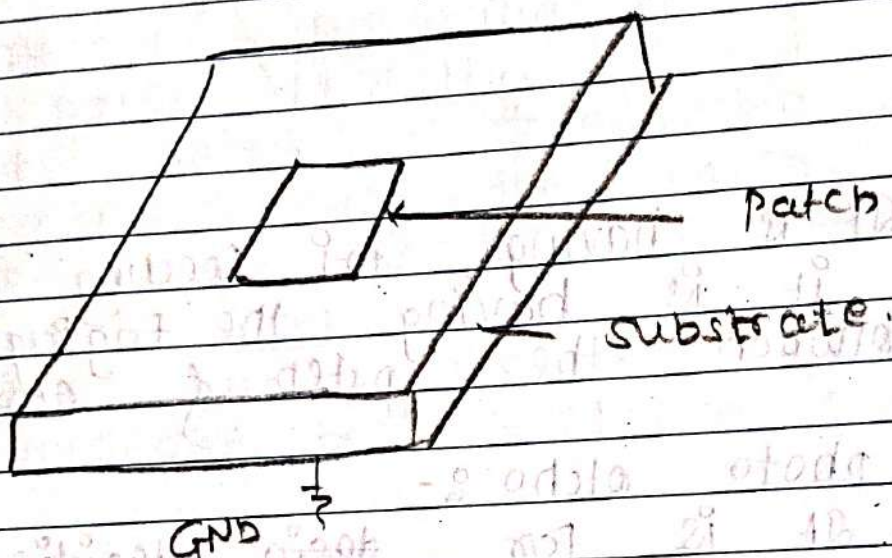

- on microstrip the patch is having any conducting material available

- one is connected to the substrate & the other is having ground.

- consider the rectangular

$$0.33\lambda_0 < b < 0.5\lambda_0$$

Advantages of microstrip antenna :-

→ fabrication is smaller

→ fabrication is complicated in optoelectronic integrated circuit small & simple in design.

- high gain.

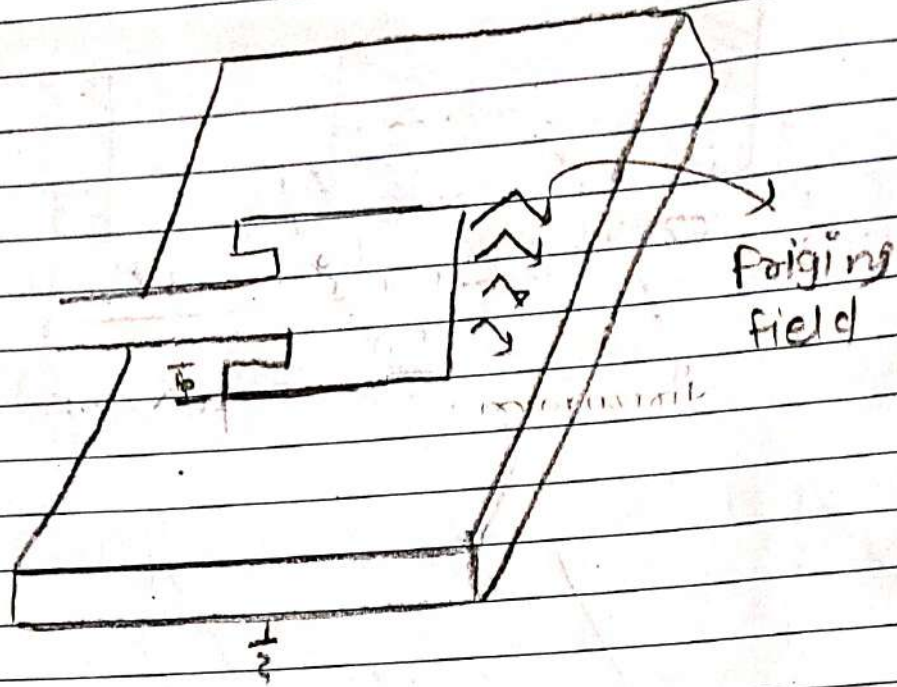

- It is having fringing field because it is having the fringing effect between the patch & ground.

- photo etch :-
It is for ~~design~~ deciding simple & complex design.

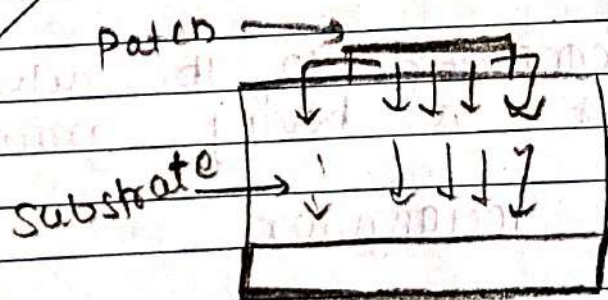

- as we are seeing in above fig the fringing effect is from patch to the substrate

- so the patch edge from that the electromagnetic waves are coming from patch to ground.

So, this effect is known as fringing effect so, that it is space.

- microstrip line

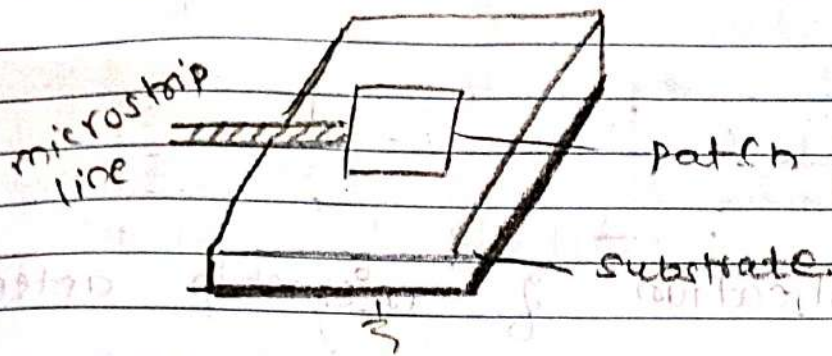

- The microstrip line is connected to the patch directly.
- The width of microstrip line is smaller than the patch.
- The feeding is done in microstrip antenna is at inset cut
- Inset cut is the for i/p match of impedance betⁿ feed line & patch.

- coaxial :-

- The inner substrate is connected to it & soldered directly
- The outer substrate is directly connected to ground.
- The feeding of coaxial feed is at any point.

- aperture :

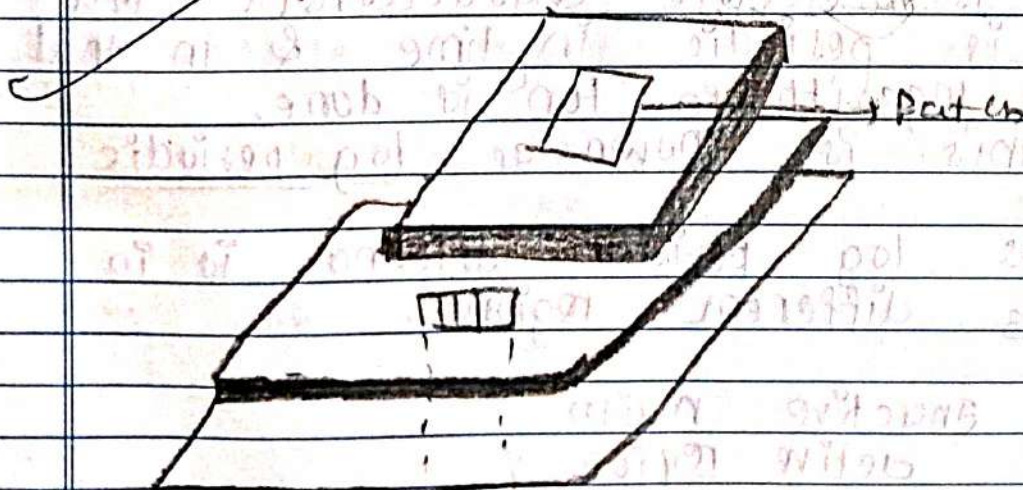

both are separated from the GND

1) Inactive region :-

- In this the impedance is that is the capacitive impedance,
- the current is lead by the 90°
- the radiation is backward as there is smaller

2) Active region :-

- the angle is in phase.
- the i/p impedance is of inductive impedance.

3) Inactive region :-

- The angle is lagging in this region.
- the impedance is because of reactive load.
- The radiation is back on left side, (maximum).

So, the log periodic is in this three region only.

$$- \frac{R_1}{R_2} = \frac{R_2}{R_3} = \dots = \frac{R_n}{R_{n+1}}$$

$$\frac{S_0}{S_1} = \frac{S_2}{S_3} = \dots = \frac{S_n}{S_{n+1}}$$

$$\boxed{\frac{1}{T} = k}$$

4) Proximity :-

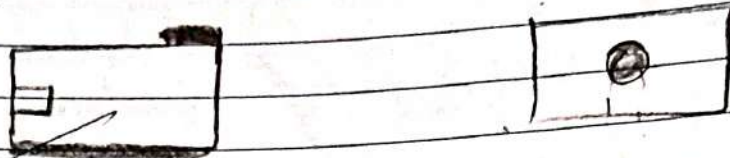

Application of microstrip antenna :-

- In mobile phones
- Industry

Q. 3

2)

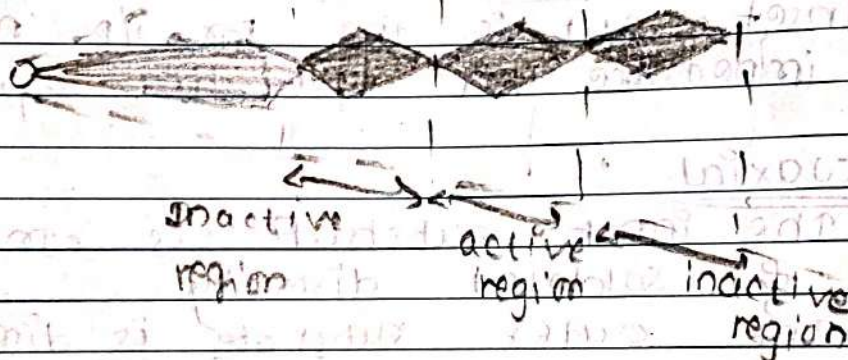

rig. log periodic antenna.

log periodic :-

It is electric characteristic that it is periodic in time & on that the logarithmic funcⁿ is done, this is known as log periodic

- as log periodic antenna is in 3 different regions :-

- 1) inactive region
- 2) active region
- 3) inactive region.

$$\frac{R_{01}}{R_{01}} = \frac{S_{01}}{S_{01}} = \gamma$$

γ is the $\frac{1}{K}$ scale

$$\frac{R_{01}}{R_0} = \frac{S_{01}}{S_0} = \frac{b}{\gamma} \quad (1)$$

is spacing betⁿ then.

characteristic :-

- 1) Its radiation is in unidirection i.e on left
- 2) Here we have taken one active region instead of 2-active regions.
- 3) here the impedance is of capacitive impedance & that is leading.
- 4) In second region the impedance is because of resistive load & there the angle is lagging.





Shri Vithal Education & Research Institute's
COLLEGE OF ENGINEERING, PANDHARPUR

ISE / Unit Test No.: _____ Date.: 1/6/22

Name of Student.: Dipti more

Class.: Ty Division.: B

Roll No.: 22 Subject.: AWP

Sign of Supervisor.: [Signature] Marks.: _____

CO:	BL	PI Code	Q.No.	a	b	c	d	e	f	Total
			1							
			2							
			3							
			4							
			5							
			6							
			7							
			8							
Grand Total										

• Advantages :-

- It is having higher bandwidth.
- low radiation.
- power

Q.3

a) spiral :-

cavity backed :-
 - the feeding is of the cavity the backed antenna.

some time we dont worry about the back radiation.

So, this is cavity backed.

g) spiral antenna :-

advantages of spiral antenna :-

- 1) an aircraft or defense military the very wideband in that they do not need require any space
- In GPS (mobile phones also we are using.

2) microwave radiation

3) 1-18 GHz freqⁿ range there only we are using

4) ultra wideband

so, here the applⁿ of spiral antenna

- 1) military
- 2) satellite commⁿ
- 3) industry
- 4) biomedical.

- 1) inner radius
- 2) outer radius
- 3) HPBW -

1) inner radius
- higher frequency

$$f_H = \frac{c}{4r_0}$$

$$r_0 = \frac{c}{4f_H}$$

2) outer freqⁿ :-

- It is having lower freqⁿ

$$= \frac{c}{\lambda}$$

$$\lambda = 2\pi r_{out}$$

$$f_l = \frac{c}{2\pi r_{out}}$$

• Flare angle :-

- Flare angle is the giving the growth of the antenna.
- that is if the growth of spiral is increases with the angle.

* Archimedean :-

- two arms of are depend on the angle betⁿ them.

$$r_0 = r_0 \psi + r_1$$

$$r_0 = r_0(\psi - 1) + r_2$$

ψ = angle betⁿ them.

- independent of freqⁿ

Rayleigh's

Rumsey's

- It is depend on the no. of

turns of angle increase or changes
 on that it is independent of
 freq?

$$\alpha = R_0 e^{\alpha y}$$

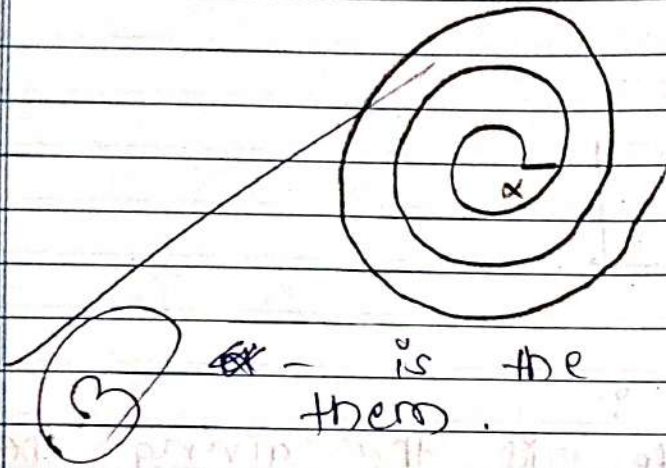

is the first angle betⁿ
 them.

Q. 4

②

structure of atmosphere

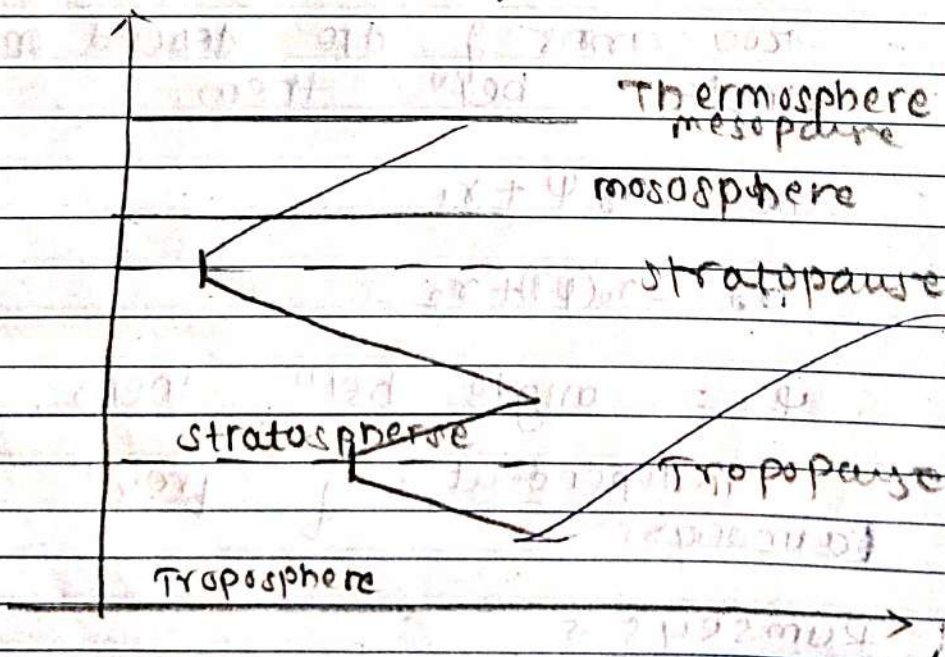



ISE / Unit Test No.: _____ Date.: 16/03

Name of Student.: Dipti more

Class.: TY Division.: B

Roll No.: 22 Subject.: AWP

Sign of Supervisor.: [Signature] Marks.: _____

CO:	BL	PI Code	Q.No.	a	b	c	d	e	f	Total
			1							
			2							
			3							
			4							
			5							
			6							
			7							
			8							
Grand Total										

- Troposphere :-
- stratosphere :-
- mesosphere :-
- Thermosphere :-

1) Troposphere :-

- The first layer is troposphere.
- On this the all the weather condition of the water vapour are present.

- This region is from 0-18 (pole) (equator) range.

Tropopause :-

It is the separate from troposphere & stratosphere.

e) stratosphere :-

In this the it is the second layers

- This range is from 18 to 50

- It is upto 50

- In this the dry conditions are observed.

stratopause :-

It separate from stratosphere & mesosphere.

3) The next layer is mesosphere

- In mesosphere it is from 50 to 400

mesopause :-

That is it separate from mesosphere & thermosphere

4) Last one is thermosphere?

In thermosphere there are
2 layers

① Ionosphere

② exosphere

Ionosphere :-

- It is first layer of atmosphere
(lowest).

- In this some electrically charges
are there that is known
as ions.

Exosphere :-

- It is the last layer of atmosphere

- after some frequency range
from there the satellites
are not giving the response

So, for that we are giving
in space ~~set~~ some
the satellite for receiving
the signal.

So, this are the layers of
atmosphere.

3



**Shri Vithal Education & Research Institute's
College of Engineering, Pandharpur**

In Semester Examination (ISE)

Result



SHRI VITHAL EDUCATION & RESEARCH INSTITUTE'S
COLLEGE OF ENGINEERING, PANDHARPUR.
Gopalpur - Ranjani Road, Gopalpur, P.B. No. 54, Tal - Pandharpur- 413 304,
Dist. Solapur (Maharashtra) Ph.: (02186) 225083, Fax: (02186) 225082.
(Approved by AICTE, New Delhi and affiliated to Solapur University, Solapur)

Electronics and Telecommunication Engineering Dept.

Class : TY(B)

Sem-I

ISE-1 record

2022-23

Roll.No.	Name	EMFT	MCA	DSP	PM/OR	DP/FE
1	BABAR PRAGATI DIGAMBAR	19	20	20	13	15
2	BHAJIBHAKARE AAKANKSHA SHIVLING	12	4	15	8	9
3	BHATTAD DISHA DINESHKUMAR	18	18	18	9	14
4	BIRAJDAR SHRADDHA APPASAHEB	16	15	16	8	12
5	DESHMUKH SHIVBHAKTI SUNIL	13	14	18	11	12
6	GARAD SHARAYU SHEKHAR	18	19	12	11	12
7	GURAV VRUSHALI VILAS	4	8	3	6	7
8	INGALE KAJAL VIJAYKUMAR	16	11	17	9	9
9	INGALE VARSHALI SANTOSH	15	9	18	7	7
10	JANAGAWALI VRUSHALI KISHOR	18	19	18	14	9
11	JOSHI SWARALI SHRIRANG	19	19	18	13	15
12	KADAM SNEHAL SHIVAJI	12	13	18	7	10
13	KADAM RUTUJA ARUN	16	12	17	10	11
14	KADLASKAR SHRUTI VITTHAL	12	15	12	10	16
15	KALA SHRUTI MUKESH	16	16	11	11	17
16	SANTANI KENNY DIPAK	18	15	18	13	15
17	KULKARNI VAIBHAVI MAHESH	11	17	17	12	15
18	KULKARNI VAISHNAVI AVINASH	6	18	17	14	14
19	MANAKOJI ANJALI MALLINATH	14	15	12	12	16
20	MISAL PRANALI KALYAN	17	13	20	10	10
21	MISAL SONALI RAMESH	10	13	11	8	11
22	MORE DIPTI DILIP	16	19	16	13	16
23	MUCHLAMBE VAISHNAVI SHARANAPPA	20	18	10	15	11
24	MULANI HEENA TAYYAB	19	19	19	10	10
25	NAIKNAVARE PRANOTI GANESH	14	18	16	11	15
26	PATIL HARSHADA SANJAY	18	16	18	10	7
27	PATIL KANCHAN KISHOR	13	15	13	9	11
28	PATIL PRATIKSHA TUKARAM	11	17	18	9	11
29	PATIL VAISHNAVI DNYANESHWAR	6	10	2	7	6
30	PAWAR SWAPNALI NAVANATH	15	10	15	13	11
31	RANANAVARE SAKSHI SANDIP	16	16	15	12	14
32	SHINDE AISHWARYA RAGHU	0	7	2	9	9
33	SHINDE ANISHA ANIL	17	16	17	14	14
34	SHINDE ANKITA SHANKAR	11	16	17	16	14
35	SHINDE SIDDHI DATTATRAYA	7	11	16	13	10
36	SHINDE VAISHNAVI BANDU	4	10	4	7	13
37	SHIRKANDE SAKSHI BALASAHEB	16	15	14	13	19
38	TAWASHE PRITI YASHWANT	19	18	20	14	20
39	UTPAT PRANJALI MILIND	6	14	8	8	10
40	VYAVAHARE KANCHAN RAJKUMAR	17	15	19	11	16
41	ADSUL ABHISHEK SHRIKANT	13	13	18	11	11
42	ATAR SAHIL NASIR	11	13	19	9	6
43	BAGEWADIKAR YASH RAJESH	7	10	7	9	13
44	BADVE VINAYAK UDAYA	4	9	5	3	7
45	BULBULE JAY SANTOSH	3	6	2	4	10
46	CHAVAN PRATHMESHI SHANTOSH	6	6	9	6	A
47	CHAVAN RITESH GANESH	19	18	18	19	18
48	CHAVAN SHUBHAM LAXMAN	10	9	12	6	10

Roll.No.	Name	EMFT	MCA	DSP	PM/OR	DP/FE
49	DIWANE SAURABH DAGDU	8	11	17	10	6
50	GAIKWAD SUYASH AUDUMBAR	13	8	5	8	8
51	GAWALOM ANIL	16	18	16	15	13
52	GHAVATE ADITYA ABASAHEB	16	15	17	15	14
53	GHONGADE PRATHAMESH RAJESH	5	11	Λ	Λ	Λ
54	JADHAV GANESH SAMBHAJI	18	12	18	12	11
55	KAMBALE SHUBHAM SHRAVAN	10	15	15	9	13
56	KAMBLE SHREYASH PRAMOD	15	12	17	10	15
57	KASABE ANMOL ASHOK	14	12	13	12	12
58	KHATKE SANDIP HANUMANT	11	15	11	9	9
59	KHULE ABHIJEET VIKAS	14	14	11	13	14
60	KORADE KUNAL KAKASAHEB	12	13	19	5	10
61	KORE AMOL ASHOK	19	15	17	15	12
62	KULKARNI VISHAL VYANKTESH	14	17	15	16	11
63	LAWATE SHIVAJI CHINTAMANI	17	18	11	13	9
64	MAGAR SHIVRAJ TANAJI	8	11	9	10	12
65	MALI TANMAY SHIVAJI	16	14	17	12	10
66	MISAL ROHIT PANDURANG	16	12	3	5	3
67	MORE ANIKET GOVARDHAN	19	11	17	12	7
68	MORE SHUBHAM BALASAHEB	13	11	16	11	9
69	MORE TUSHAR DHANANJAY	18	10	18	15	10
70	PATIL ARJUN VIJAYKUMAR	20	11	9	8	9
71	PATIL DEEPAK RAJKUMAR	11	14	14	11	12
72	PATIL KEDAR SIDRAM	10	14	15	11	12
73	SHELAR SAGAR SHRIGANESH	8	13	17	10	11
74	UBALE AVISHKAR GORAKH	8	14	15	12	13
75	VADAJE MAHADEV BHIMASHANKAR	4	12	7	4	12
76	YADAV PRATIK ANIL	7	16	12	8	13

Result Analysis

	EMFT	MCA	DSP	PM/OR	DP/FE
Total no of students	76	76	76	76	76
No. of Students appeared for the TEST	76	76	75	75	74
No. of absent Students	0	0	1	1	2
No. of Passed Students	62	72	65	63	65
No. of Students failed	14	4	10	12	9
No. of students scored marks between 40% to 50%	8	10	5	25	19
No. of students scored marks between 51% to 60%	10	14	10	17	19
No. of students scored marks between 61% to 70%	10	14	4	13	13
No. of students scored marks between 71% to 80%	14	17	13	7	10
No. of students scored marks between 81% to 99%	18	16	30	1	3
No. of students scored marks= 100%	2	1	3	0	1
Sign of Subject Teacher					

Class Coordinator

HOD ENTIC



**Shri Vithal Education & Research Institute's
College of Engineering, Pandharpur**

Internal Continuous Assessment (ICA) Circular



Shri Vitthal Education & Research Institute's
COLLEGE OF ENGINEERING, PANDHARPUR

P.B.No. 54, Gopalpur - Ranjani Road, Gopalpur, Pandharpur - 413 304, Dist. Solapur (Maharashtra) Tel.: 7755990201.

Tel Free No.- 1800-3000-4131, E-mail: coe@sveri.ac.in, Website: www.sveri.ac.in (Approved by A.I.C.T.E., New Delhi and Affiliated to Solapur University, Solapur)

Accredited by The Indian Institution of Engineers (India), Kolkata and TCS, Pune. ISO 9001:2008 Certified Institute



Ref:- COEPR/2017-18/66108

Date:- 03/04/2018

Circular

All the staff and students are hereby informed to note that the modified policy for giving Internal Continuous Assessment (ICA) (term work) marks is as per the details given below:

PART-I: Continuous Evaluation

Sr. No.	Particular	Split of Marks out of 25	
		For subjects with practice Session	For subjects without practice Session
A. Subjects with only Assignments / Tutorials			
		A1	A2
1.	Assignment / Tutorial (Timely submission and presentation of write up)	08	10
2.	Attendance in Practice Session	04	00
3.	Unit Tests (03 tests X 02 Marks)	06	06
4.	PPPE write up	05	07
5.	Oral	02	02
	Total	25	25
B. Subjects with Lab Practical and Assignments / Tutorials			
		B1	B2
1.	Assignment / Tutorial (Timely submission and presentation of write up)	03	04
2.	Lab Book (Timely submission and presentation of write up)	05	06
3.	Attendance in Practice Session	03	00
4.	Unit Tests (03 tests X 02 Marks)	06	06
5.	PPPE write up	04	04
6.	Oral	02	02
7.	Lab Tests	02	03
	Total	25	25
C. Subjects with only Lab Practicals without Theory Paper			
		C1	C2
1.	Lab Book (Timely submission and presentation of write up)	06	06
2.	Timely completion of Practical	05	05
3.	PPPE write up	02*	02*
4.	Oral	05	05
5.	Lab Tests	07	07
	Total	25	25

B. Range

Note: *For the subjects with no theory lectures, these one mark should be added to "Timely Completion of Practical and Performance" and "Lab Book (Timely submission and presentation of write up)" making corresponding marks as '06', '06' and '07', '07', respectively.

Part-II: Attendance and Professional Behavior

A. Effect of Attendance on ICA (Term Work) Marks

Sr. No.	Percentage Attendance.	Variation in the Final Marks
1	100	+3
2	95-99	+1
3	90-94	No Effect i.e. 0
4	85-89	-2
5	80-84	-3

B. Total marks obtained by a student will be further smoothened /modified based on general behavior and participation of the student. The authority to smoothen/modify the marks based on this point shall be with HoD. However, exceptional cases be taken to Principal through Dean Students.

Note:

1. The detailed procedure for continuous evaluation and allocating marks with respect to each of the tools as per the type of subject is given in **Annexure-I**.
2. The above policy is for subjects having ICA (Term Work) marks out of 25. For the subjects having ICA marks other than 25, proportional conversion of the ICA (Term Work) marks be done.
3. Soft copy of the excel Sheets as per the type of subjects will be loaded on the FTP for assisting students to verify the correctness in their Term Work marks.
4. The earlier circular on 5+2 point formula dated 20/10/2014 with ref no. COEPR/2014-15/CIR/33 stands cancelled w.e.f 01/01/2018.
5. All the subject teachers have to update their files with this Circular in place of the previous circular dated 20/10/2014.

All the concerned should take the note of the above and act accordingly.

B. Ronge
(Dr. B. P. Ronge)
PRINCIPAL



Annexure-I: Progressive Assessment Guidelines

I] Progressive Assessment of Lab Books, Assignments or tutorials should be assessed out of 25 Marks for each Lab Practical/Assignment/Tutorial

1. **Lab Book** shall be assessed as given below:

Attendance	Performance in Lab	Submission	Presentation	Oral	Total
Out of 5 Marks	Out of 5 Marks	Out of 5 Marks	Out of 5 Marks	Out of 5 Marks	Out of 25 Marks

Attendance: If the student is present for practical session should be given 5 marks, if he/she performs same practical in next session allot him/her 4 marks and reduce 1 mark for each subsequent session. Minimum 1 mark should be given if he/she performs practical during the semester.

Performance in Lab: Teacher should observe the performance of individual student e.g. Initiative, Reading taking, etc. It is expected to observe the student how he/she performs at the time of practical session. Faculty members should ensure that every student take initiative and perform the practical and in such cases accordingly 5 marks be given. Marks be allotted as per the involvement of the students.

Submission: Students are supposed to submit lab book in time. If he/she submits the practical writeup in same or immediate next practical session, give 5 marks and if he/she fails to submit 1 mark each be reduced for every subsequent session. If he/she submits the lab book thereafter during the semester 1 mark be given. And if he/she submits lab book during the semester 1 mark be given.

Presentation: Teacher should assess the lab book by verifying the neatness, content of write up, results and conclusion. This is subjective, if teacher finds lab work as per requirements 5 marks be given. Results and conclusion shall be based on what is understood/observed by the student and how the output is interpreted by the student.

Oral: Student be asked queries related to practical/ theory, and based on student's performance marks be allotted.

Note: For B1 and B2: The total marks of all experiments in Lab Book be converted out of 5 /6 marks at Sr. No. 1 under B in PART-I i.e. "Lab Book (Timely submission and presentation of writeup)", as the case may be.

For C1 and C2: The total marks of all experiments in Lab Book be converted out of 6 /7 marks at Sr. No. 1 under C in PART-I i.e. "Lab Book (Timely submission and presentation of writeup)", as the case may be, and marks related to Sr. No. 2 under C in PART-I i.e. "Timely

B. Dose



completion of Practicals" be linked with the attendance of Practicals and be converted out of 5/6 marks as follows:

Attendance in %*	Marks
100	5/6
95-99	4/5
90-94	3/4

Attendance in %*	Marks
85-89	2/3
80-84	1/2
Below 80 and Completed by extra sessions	0/1

* Sanctioned leave be considered as attendance after completion of the particular practical during extra session.

2. Each Assignment be assessed on the basis of timely submission (10 M), presentation (10 M) and oral (5 M)

Timely Submission	Presentation	Oral	Total
Out of 10 Marks	Out of 10 Marks	Out of 5 Marks	Out of 25 Marks

Timely Submission: Student is supposed to submit the assignment within the stipulated time to get full marks. If student fails to submit the assignment in time, 1 mark each for every late day be reduced. However, thereafter for the submission of the assignment during the semester he/she be given 2 marks.

Presentation: Presentation of assignment be judged based on contents, neatness, completeness, etc.

Oral: Questions on assignment be asked to verify the understanding of the student. If the student fails to answer, he/she be asked to prepare and appear for the oral once again. Marks be given based on oral performance.

Note: The total marks of all assignments in the assignment book be converted; out of 8 or 10 at Sr. No. 1 under A1 and A2, respectively and out of 3 or 4 at Sr. No. 1 under B1 and B2, respectively in PART-I i.e. "Assignment / Tutorial (Timely submission and presentation of write up)".

B. P. Jc

II] Progressive Assessment for "Attendance in Practice Session":

- Attendance record of practice sessions be maintained separately.
- "Attendance in Practice Session" marks at Sr. No. 2 under A at A1 and Sr. No. 3 under B at B1 in PART-I be allotted based on attendance of practice sessions as given below:

Sr. No.	Percentage of Practice Session Attendance*	A1	B1
1	100	4	3
2	90-99	3	2
3	85-89	2	1
4	80-84	1	1
5	75-79	0	0
6	Below 75	-1	-1

* Rounding be done to upper integer number

III] Progressive Assessment for "Unit Tests" (6 Marks):

- Minimum 3 unit tests be conducted as per ESE pattern i.e. 20% MCQs and 80% subjective questions.
- These tests be on syllabus of Unit No. 1, 3, 5, etc.
- **Final ICA (Term Work) marks distribution be as follows:**

Sr. No.	Particulars	Percentage marks in all the tests together	Marks to be given out of 6
1.	Student passes in all unit tests	80 and Above	6
2.	Student passes in all unit tests	70 and Above	5
3.	Student passes in all unit tests	60 and Above	4
4.	Student passes in all unit tests	50 and Above	3
5.	Student fails in or remains absent for any one of the unit tests	-	2
6.	Student fails in or remains absent for any two of the unit tests	-	1
7.	Student fails in or remains absent for all the unit tests	-	0

Note:

1. Above provisions are for subjects with 70 marks ESE. Modifications be made accordingly, for subjects having different marks for ESE.
2. Student, failing in or remaining absent for the test or willing to improve, at his/her choice may opt for retest, within 5 days from the date of declaration of the result, once for each test by paying charges of Rs. 100/- per test. Best performance be retained.

B. Pange



IV] Progressive Assessment for “PPPE write up”:

- PPPE write up be checked at every practical/tutorial session by respective teacher.
- If there is no practical/tutorial session, one day in the week be decided by the concerned teacher for getting PPPE write up checked.
- Assessment Marks for each session be out of 10 and be given based on the following criterion:

Submission	Presentation	Oral	Total
(Out of 5 Marks)	(Out of 3 Marks)	(Out of 2 Marks)	(Out of 10 Marks)

Submission: Five (5) marks be given if the student submits the PPPE writeup in immediate next practical/tutorial session or the day assigned, as the case may be. If there is delay in submission, 1 mark each be reduced for every subsequent session. However, 1 mark be given for submission thereafter during the semester.

Presentation: Teacher should assess the PPPE write up by verifying the neatness, contents, completeness, etc. of the write up. Three (3) marks be given, if the teacher finds PPPE write up as per the requirements.

Oral: Questions on PPPE writeup be asked to verify the understanding of the student. If the student fails to answer, he/she be asked to prepare and appear for the oral once again. Marks be given based on oral performance.

Note: The total marks of all PPPE write up be converted; out of 5 or 7 at Sr. No. 4 in A under A1 and A2, respectively, out of 4 at Sr. No. 5 in B under both B1 and B2, and out of 2 at Sr. No. 3 in C under both C1 and C2, if applicable, in PART-I i.e. “PPPE write up”.

V) Progressive assessment for “Lab Tests”:

- Two Lab Tests be conducted during the semester, in line with first two ISEs, for the subjects where students have to perform experimental practicals.
- Weightage for each Lab Test be of 20 marks as per the distribution given below:

Conduct of Experiment	Presentation	Results and Conclusion	Oral	20 Marks
Out of 10	Out of 3	Out of 5	Out of 2	Out of 20

Conduct of Experiment: Ten (10) marks be given if the student conducts experiment as per the standard procedure of the experiment. If the experiment is not completed, appropriate marks be given based on number of steps completed.

Presentation: Teacher should assess the Lab Test write up by verifying the neatness, contents, completeness, etc. of the write up. Three (3) marks be given, if the teacher finds the write up as per the requirements.

B. B. Singh

Results and Conclusion: Five (5) marks be given if the results are appropriate and proper conclusion is drawn.

Oral: Questions on Lab Test be asked to verify the understanding of the student. If the student fails to answer, he/she be asked to prepare and appear for the oral once again. Marks be given based on oral performance.

Final ICA (Term Work) marks distribution be as follows:

Sr. No.	Particulars	Percentage marks in all the tests together	B1 (Out of 2 Marks)	B2 (Out of 3 Marks)	C1 and C2 (Out of 7 Marks)
1.	Student passes in all Lab Tests	80 and Above	2	3	7
2.	Student passes in all Lab Tests	70 and Above	1	2	5
3.	Student passes in all Lab Tests	60 and Above	1	1	4
4.	Student passes in all Lab Tests	50 and Above	1	1	3
5.	Student fails in or remains absent for any one of the Lab Tests	-	0	0	0
6.	Student fails in or remains absent for all the Lab Tests	-	-1	-1	-1

Note:

Student, failing in or remaining absent for the Lab Tests or willing to improve, at his/her choice may opt for retest, within 5 days from the date of declaration of the result, once for each test by paying charges of Rs. 100/- per Lab Test. Best performance be retained.

B. Panje



**Shri Vitthal Education & Research Institute's
College of Engineering, Pandharpur**

Internal Continuous Assessment (ICA) Tools

- **Assignment**
- **Journal**
- **Chapter Test/Unit Test (CT/UT)**
- **Lab Test (LT)**



**Shri Vithal Education & Research Institute's
College of Engineering, Pandharpur**

Internal Continuous Assessment (ICA) Tools

Assignment

INDEX

(Assignment / Tutorial Book Assessment)

Sr. No.	Title of Assignment / Tutorial	Page No.	CO	Date of Assign./Tut.		Marks (25)			Total Marks (25)	Sign.
				Given	Checked	Timely Submission (10)	Presentation (10)	Oral (5)		
1	Data communication and Network	1	CO1	19/08	20/9	10	10	4	24	M. Bisnoi 20/9/2022
2	Data link layer	17	CO2	7/09	11/10	10	10	3	23	M. Bisnoi 11/10/2022
3	Wireless LAN standards	27	CO3	8/10	12/10	10	10	3	23	M. Bisnoi 12/10
4	Network layer	34	CO4	17/10	1/11	10	10	4	24	M. Bisnoi 1/11
5	Transport layer	41	CO5	31/10	15/11	10	10	4	24	M. Bisnoi 15/11
6	Application Protocols	-	CO6	20/11	28/11	10	10	4	24	M. Bisnoi 28/11

CERTIFICATE

This is certify that ~~Mr.~~ / Miss. / Mrs. Shreya Dipak Kulkarni..... of Class L.T.E&TC Division B..... Roll No 14..... Semester VII..... has completed satisfactorily Assignments/Tutorials in Data Communication. during the academic year 2022-23

Date : 24/12/2022

Subject Teacher

Head of Dept.

Principal